

Flow Switches – Liquid

Series FS5 (for specified models) General Purpose Liquid Flow Switches

- For general purpose applications requiring low flow rate sensitivity
- In-line configuration eliminates need for a pipe tee
- Sizes available
 - 3/4" NPT
 - 1" NPT
- Materials of construction
 - Brass, carbon & EPDM elastomer (for water); Models FS5 & FS5-D
 - Stainless steel, carbon & Buna N (for water or water and petroleum base compounds) Models FS5-S & FS5-DS
- Single pole, double throw snap switch
- Sensitivity adjusting screw makes flow adjustment easy
- Optional feature
 - BSPT threads
- Minimum temperature (fluid or ambient) 32°F (0°C)
- Maximum temperature
 - 225°F (107°C) – Stainless Steel models
 - 250°F (121°C) – Brass
- Maximum operating pressure 150 psi (10.5 kg/cm²)

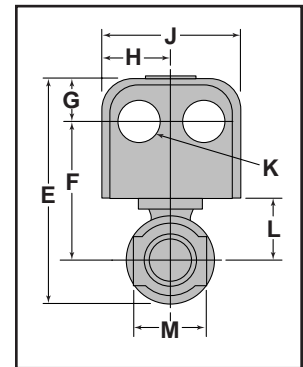
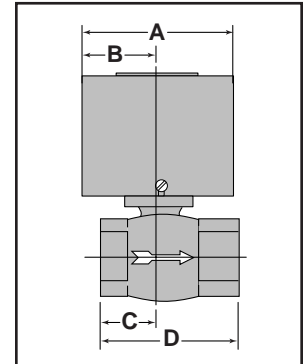
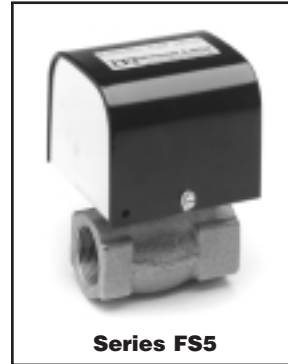

Electrical Ratings

| Voltage | Motor Switch Rating (Amperes) | | Pilot Duty |
|---------|-------------------------------|--------------|--|
| | Full Load | Locked Rotor | |
| 120 VAC | 7.4 | 44.4 | 125 VA at 120 or 240 VAC 50 or 60 cycles |
| 240 VAC | 3.7 | 22.2 | |

Ordering Information

| Model Number | Part Number | Description | Weight lbs. (kg) |
|--------------|-------------|---|------------------|
| FS5-3/4 | 114760 | General purpose flow switch 3/4" NPT | 2.5 (1.1) |
| FS5-D-3/4 | 114763 | FS5-3/4 w/2 SPDT switches | 2.5 (1.1) |
| FS5-J-3/4 | 114765 | FS5-3/4 w/BSPT connections | 2.5 (1.1) |
| FS5-1 | 114780 | General purpose flow switch 1" NPT | 2.5 (1.1) |
| FS5-D-1 | 114783 | FS5-1 w/2 SPDT switches | 2.5 (1.1) |
| FS5-J-1 | 114785 | FS5-1 w/BSPT connections | 2.5 (1.1) |
| FS5-S-1 | 114795 | FS5-1 w/SS body | 2.3 (1.0) |
| FS5-DS-1 | 114793 | FS5-1 w/SS body, 2 SPDT switches | 2.5 (1.1) |
| FS5-J-3/4-E | 114766 | FS5-J-3/4 - CE conformance rated | 2.5 (1.1) |
| FS5-J-1-E | 114787 | FS5-J-1 - CE conformance rated | 2.5 (1.1) |

See page 157 for CE Conformance information

Dimensions, in. (mm)

| A | B | C | D |
|-------------------------------------|-------------------------------------|-------------------------------------|-------------------------------------|
| 3 ⁷ / ₁₆ (87) | 1 ⁹ / ₁₆ (40) | 1 ⁵ / ₁₆ (33) | 3 ³ / ₁₆ (56) |

| E | F | G | H |
|--------------------------------------|------------------------------------|-------------------------------------|--|
| 5 ¹ / ₁₆ (129) | 3 ¹ / ₄ (83) | 7 ⁸ / ₁₆ (22) | 1 ¹⁹ / ₃₂ (40.5) |

| J | K | L | M |
|-------------------------------------|-------------------------------------|------------------------------------|--------------------------------------|
| 3 ³ / ₁₆ (81) | 7 ⁸ / ₁₆ (22) | 1 ³ / ₈ (35) | 1 ¹¹ / ₁₆ (43) |

Flow Rates

| Pipe Size NPT in. | Settings | Mode of Operation | | Max. Flow Rate gpm (lpm) w/o Paddle Damage |
|-------------------|--------------------|-------------------|-------------------|--|
| | | Flow gpm (lpm) | No Flow gpm (lpm) | |
| 3/4 or 1 | Factory or Minimum | 1.5 (5.7) | 1.1 (4.2) | 16.62 (62.9) |
| | Maximum | 15 (56.8) | 10 (37.9) | 27 (102.2) |

Values are ± 10%

NOTE: DO NOT USE LIQUID FLOW SWITCHES ON SYSTEMS WITH FLOW GREATER THAN 10 FEET (3M) PER SECOND.